

## Replacement parts suitable for RAYTOOLS<sup>®</sup>

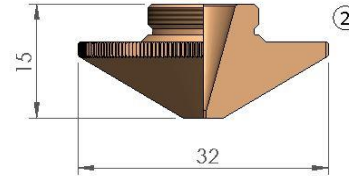
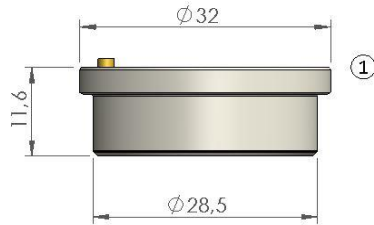

POS	LS. CODE	ORIGINAL CODE	DESCRIPTION	unit price	5 pack price
1	069001		RAYTOOLS <sup>®</sup> CERAMIC NOZZLE HOLDER		
2	061001		RAYTOOLS <sup>®</sup> NOZZLE Ø 0.8		
	061001V		RAYTOOLS <sup>®</sup> NOZZLE Ø 0.8		
	061002		RAYTOOLS <sup>®</sup> NOZZLE Ø 1.0		
	061002V		RAYTOOLS <sup>®</sup> NOZZLE Ø 1.0		
	061003		RAYTOOLS <sup>®</sup> NOZZLE Ø 1.2		
	061003V		RAYTOOLS <sup>®</sup> NOZZLE Ø 1.2		
	061004		RAYTOOLS <sup>®</sup> NOZZLE Ø 1.4		
	061004V		RAYTOOLS <sup>®</sup> NOZZLE Ø 1.4		
	061005		RAYTOOLS <sup>®</sup> NOZZLE Ø 1.5		
	061005V		RAYTOOLS <sup>®</sup> NOZZLE Ø 1.5		
	061006		RAYTOOLS <sup>®</sup> NOZZLE Ø 1.8		
	061006V		RAYTOOLS <sup>®</sup> NOZZLE Ø 1.8		
	061007		RAYTOOLS <sup>®</sup> NOZZLE Ø 2.0		
	061007V		RAYTOOLS <sup>®</sup> NOZZLE Ø 2.0		
	061008		RAYTOOLS <sup>®</sup> NOZZLE Ø 2.3		
	061008V		RAYTOOLS <sup>®</sup> NOZZLE Ø 2.3		
	061009		RAYTOOLS <sup>®</sup> NOZZLE Ø 2.5		
	061009V		RAYTOOLS <sup>®</sup> NOZZLE Ø 2.5		
	061010		RAYTOOLS <sup>®</sup> NOZZLE Ø 2.75		
	061010V		RAYTOOLS <sup>®</sup> NOZZLE Ø 2.75		
	061011		RAYTOOLS <sup>®</sup> NOZZLE Ø 3.0		
	061011V		RAYTOOLS <sup>®</sup> NOZZLE Ø 3.0		
	061012		RAYTOOLS <sup>®</sup> NOZZLE Ø 3.2		
	061012V		RAYTOOLS <sup>®</sup> NOZZLE Ø 3.2		
	061013		RAYTOOLS <sup>®</sup> NOZZLE Ø 3.5		
	061013V		RAYTOOLS <sup>®</sup> NOZZLE Ø 3.5		
	061014		RAYTOOLS <sup>®</sup> NOZZLE Ø 4.0		
	061014V		RAYTOOLS <sup>®</sup> NOZZLE Ø 4.0		
	061015		RAYTOOLS <sup>®</sup> NOZZLE Ø 4.5		
	061015V		RAYTOOLS <sup>®</sup> NOZZLE Ø 4.5		
	061016		RAYTOOLS <sup>®</sup> NOZZLE Ø 5.0		
	061016V		RAYTOOLS <sup>®</sup> NOZZLE Ø 5.0		
061017		RAYTOOLS <sup>®</sup> NOZZLE Ø 6.0			
061017V		RAYTOOLS <sup>®</sup> NOZZLE Ø 6.0			

Laser Store srl is not affiliated with the named manufacturers. Reference to machines, parts, descriptions, and model numbers are for convenience in verifying compatibility only. All parts are made by or for Laser Store srl and are not made by the reference manufactures (unless expressly indicated). All other trademarks are the properties of their respective owners."

## Replacement parts suitable for RAYTOOLS<sup>®</sup>

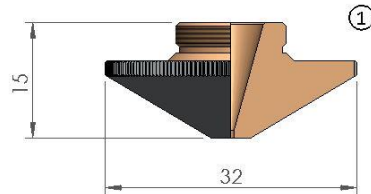

POS	LS. CODE	ORIGINAL CODE	DESCRIPTION	unit price	5 pack price
1	061001C		RAYTOOLS <sup>®</sup> NOZZLE Ø 0.8 CP		
	061001CV		RAYTOOLS <sup>®</sup> NOZZLE Ø 0.8 CP		
	061002C		RAYTOOLS <sup>®</sup> NOZZLE Ø 1.0 CP		
	061002CV		RAYTOOLS <sup>®</sup> NOZZLE Ø 1.0 CP		
	061003C		RAYTOOLS <sup>®</sup> NOZZLE Ø 1.2 CP		
	061003CV		RAYTOOLS <sup>®</sup> NOZZLE Ø 1.2 CP		
	061004C		RAYTOOLS <sup>®</sup> NOZZLE Ø 1.4 CP		
	061004CV		RAYTOOLS <sup>®</sup> NOZZLE Ø 1.4 CP		
	061005C		RAYTOOLS <sup>®</sup> NOZZLE Ø 1.5 CP		
	061005CV		RAYTOOLS <sup>®</sup> NOZZLE Ø 1.5 CP		
	061006C		RAYTOOLS <sup>®</sup> NOZZLE Ø 1.8 CP		
	061006CV		RAYTOOLS <sup>®</sup> NOZZLE Ø 1.8 CP		
	061007C		RAYTOOLS <sup>®</sup> NOZZLE Ø 2.0 CP		
	061007CV		RAYTOOLS <sup>®</sup> NOZZLE Ø 2.0 CP		
	061008C		RAYTOOLS <sup>®</sup> NOZZLE Ø 2.3 CP		
	061008CV		RAYTOOLS <sup>®</sup> NOZZLE Ø 2.3 CP		
	061009C		RAYTOOLS <sup>®</sup> NOZZLE Ø 2.5 CP		
	061009CV		RAYTOOLS <sup>®</sup> NOZZLE Ø 2.5 CP		
	061010C		RAYTOOLS <sup>®</sup> NOZZLE Ø 2.75 CP		
	061010CV		RAYTOOLS <sup>®</sup> NOZZLE Ø 2.75 CP		
	061011C		RAYTOOLS <sup>®</sup> NOZZLE Ø 3.0 CP		
	061011CV		RAYTOOLS <sup>®</sup> NOZZLE Ø 3.0 CP		
	061012C		RAYTOOLS <sup>®</sup> NOZZLE Ø 3.2 CP		
	061012CV		RAYTOOLS <sup>®</sup> NOZZLE Ø 3.2 CP		
	061013C		RAYTOOLS <sup>®</sup> NOZZLE Ø 3.5 CP		
	061013CV		RAYTOOLS <sup>®</sup> NOZZLE Ø 3.5 CP		
	061014C		RAYTOOLS <sup>®</sup> NOZZLE Ø 4.0 CP		
	061014CV		RAYTOOLS <sup>®</sup> NOZZLE Ø 4.0 CP		
	061015C		RAYTOOLS <sup>®</sup> NOZZLE Ø 4.5 CP		
	061015CV		RAYTOOLS <sup>®</sup> NOZZLE Ø 4.5 CP		
	061016C		RAYTOOLS <sup>®</sup> NOZZLE Ø 5.0 CP		
	061016CV		RAYTOOLS <sup>®</sup> NOZZLE Ø 5.0 CP		
061017C		RAYTOOLS <sup>®</sup> NOZZLE Ø 6.0 CP			
061017CV		RAYTOOLS <sup>®</sup> NOZZLE Ø 6.0 CP			

---

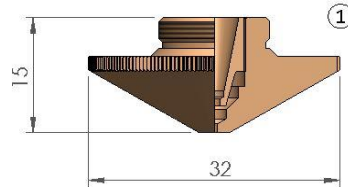

---

 Replacement parts suitable for RAYTOOLS<sup>®</sup>

POS	LS. CODE	ORIGINAL CODE	DESCRIPTION	unit price	5 pack price
1	061024		RAYTOOLS <sup>®</sup> DOUBLE NOZZLE Ø 0.8		
	061024V		RAYTOOLS <sup>®</sup> DOUBLE NOZZLE Ø 0.8		
	061025		RAYTOOLS <sup>®</sup> DOUBLE NOZZLE Ø 1.0		
	061025V		RAYTOOLS <sup>®</sup> DOUBLE NOZZLE Ø 1.0		
	061026		RAYTOOLS <sup>®</sup> DOUBLE NOZZLE Ø 1.2		
	061026V		RAYTOOLS <sup>®</sup> DOUBLE NOZZLE Ø 1.2		
	061027		RAYTOOLS <sup>®</sup> DOUBLE NOZZLE Ø 1.4		
	061027V		RAYTOOLS <sup>®</sup> DOUBLE NOZZLE Ø 1.4		
	061028		RAYTOOLS <sup>®</sup> DOUBLE NOZZLE Ø 1.5		
	061028V		RAYTOOLS <sup>®</sup> DOUBLE NOZZLE Ø 1.5		
	061029		RAYTOOLS <sup>®</sup> DOUBLE NOZZLE Ø 1.8		
	061029V		RAYTOOLS <sup>®</sup> DOUBLE NOZZLE Ø 1.8		
	061030		RAYTOOLS <sup>®</sup> DOUBLE NOZZLE Ø 2.0		
	061030V		RAYTOOLS <sup>®</sup> DOUBLE NOZZLE Ø 2.0		
	061031		RAYTOOLS <sup>®</sup> DOUBLE NOZZLE Ø 2.3		
	061031V		RAYTOOLS <sup>®</sup> DOUBLE NOZZLE Ø 2.3		
	061032		RAYTOOLS <sup>®</sup> DOUBLE NOZZLE Ø 2.5		
	061032V		RAYTOOLS <sup>®</sup> DOUBLE NOZZLE Ø 2.5		
	061033		RAYTOOLS <sup>®</sup> DOUBLE NOZZLE Ø 2.7		
	061033V		RAYTOOLS <sup>®</sup> DOUBLE NOZZLE Ø 2.7		
	061034		RAYTOOLS <sup>®</sup> DOUBLE NOZZLE Ø 3.0		
	061034V		RAYTOOLS <sup>®</sup> DOUBLE NOZZLE Ø 3.0		
	061035		RAYTOOLS <sup>®</sup> DOUBLE NOZZLE Ø 3.5		
	061035V		RAYTOOLS <sup>®</sup> DOUBLE NOZZLE Ø 3.5		
	061036		RAYTOOLS <sup>®</sup> DOUBLE NOZZLE Ø 4.0		
	061036V		RAYTOOLS <sup>®</sup> DOUBLE NOZZLE Ø 4.0		
	061037		RAYTOOLS <sup>®</sup> DOUBLE NOZZLE Ø 4.5		
	061037V		RAYTOOLS <sup>®</sup> DOUBLE NOZZLE Ø 4.5		
	061038		RAYTOOLS <sup>®</sup> DOUBLE NOZZLE Ø 5.0		
	061038V		RAYTOOLS <sup>®</sup> DOUBLE NOZZLE Ø 5.0		
061039		RAYTOOLS <sup>®</sup> DOUBLE NOZZLE Ø 6.0			
061039V		RAYTOOLS <sup>®</sup> DOUBLE NOZZLE Ø 6.0			

---

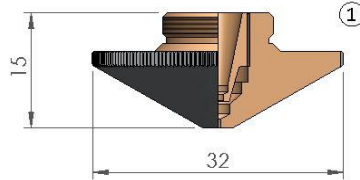

---

 Replacement parts suitable for RAYTOOLS<sup>®</sup>

POS	LS. CODE	ORIGINAL CODE	DESCRIPTION	unit price	5 pack price
1	061024C		RAYTOOLS <sup>®</sup> DOUBLE NOZZLE Ø 0.8 CP		
	061024CV		RAYTOOLS <sup>®</sup> DOUBLE NOZZLE Ø 0.8 CP		
	061025C		RAYTOOLS <sup>®</sup> DOUBLE NOZZLE Ø 1.0 CP		
	061025CV		RAYTOOLS <sup>®</sup> DOUBLE NOZZLE Ø 1.0 CP		
	061026C		RAYTOOLS <sup>®</sup> DOUBLE NOZZLE Ø 1.2 CP		
	061026CV		RAYTOOLS <sup>®</sup> DOUBLE NOZZLE Ø 1.2 CP		
	061027C		RAYTOOLS <sup>®</sup> DOUBLE NOZZLE Ø 1.4 CP		
	061027CV		RAYTOOLS <sup>®</sup> DOUBLE NOZZLE Ø 1.4 CP		
	061028C		RAYTOOLS <sup>®</sup> DOUBLE NOZZLE Ø 1.5 CP		
	061028CV		RAYTOOLS <sup>®</sup> DOUBLE NOZZLE Ø 1.5 CP		
	061029C		RAYTOOLS <sup>®</sup> DOUBLE NOZZLE Ø 1.8 CP		
	061029CV		RAYTOOLS <sup>®</sup> DOUBLE NOZZLE Ø 1.8 CP		
	061030C		RAYTOOLS <sup>®</sup> DOUBLE NOZZLE Ø 2.0 CP		
	061030CV		RAYTOOLS <sup>®</sup> DOUBLE NOZZLE Ø 2.0 CP		
	061031C		RAYTOOLS <sup>®</sup> DOUBLE NOZZLE Ø 2.3 CP		
	061031CV		RAYTOOLS <sup>®</sup> DOUBLE NOZZLE Ø 2.3 CP		
	061032C		RAYTOOLS <sup>®</sup> DOUBLE NOZZLE Ø 2.5 CP		
	061032CV		RAYTOOLS <sup>®</sup> DOUBLE NOZZLE Ø 2.5 CP		
	061033C		RAYTOOLS <sup>®</sup> DOUBLE NOZZLE Ø 2.7 CP		
	061033CV		RAYTOOLS <sup>®</sup> DOUBLE NOZZLE Ø 2.7 CP		
	061034C		RAYTOOLS <sup>®</sup> DOUBLE NOZZLE Ø 3.0 CP		
	061034CV		RAYTOOLS <sup>®</sup> DOUBLE NOZZLE Ø 3.0 CP		
	061035C		RAYTOOLS <sup>®</sup> DOUBLE NOZZLE Ø 3.5 CP		
	061035CV		RAYTOOLS <sup>®</sup> DOUBLE NOZZLE Ø 3.5 CP		
	061036C		RAYTOOLS <sup>®</sup> DOUBLE NOZZLE Ø 4.0 CP		
	061036CV		RAYTOOLS <sup>®</sup> DOUBLE NOZZLE Ø 4.0 CP		
	061037C		RAYTOOLS <sup>®</sup> DOUBLE NOZZLE Ø 4.5 CP		
	061037CV		RAYTOOLS <sup>®</sup> DOUBLE NOZZLE Ø 4.5 CP		
	061038C		RAYTOOLS <sup>®</sup> DOUBLE NOZZLE Ø 5.0 CP		
	061038CV		RAYTOOLS <sup>®</sup> DOUBLE NOZZLE Ø 5.0 CP		
	061039C		RAYTOOLS <sup>®</sup> DOUBLE NOZZLE Ø 6.0 CP		
	061039CV		RAYTOOLS <sup>®</sup> DOUBLE NOZZLE Ø 6.0 CP		